

Midwest Philatelic Society – Building Club Exhibiting Frames

Our meeting room is located in a public library and is large enough to accommodate 40 to 50 club members, 8 to 10 sturdy 6-foot folding tables and sufficient seating for presenting stamp programs and a stamp auction. Closed doors separate our meeting from other library patrons, and an armed security guard patrols the property.

Purchasing standard APS 16-page frames was too expensive for us – not to mention the extra effort moving them from one location to another. The meeting room was not large enough to accommodate 6 APS style easels, and continue to comfortably move around the room. “Club Exhibiting” was a new concept for many of our members. Some participated in AAPE/WSP organized exhibiting in years gone by, and a few still do. Most members knew nothing about exhibiting regardless of the format offered by anyone. Other members were not sure they were interested in participating, and are still thinking about it.

Since we already had 6-foot folding tables, the logical decision was to construct frames that would fit on top of them. A 6-foot table can comfortably accommodate 2 easels (each easel have 2 frames). And 6 easels would require 3 tables, allowing 12 club members to participate in our exhibiting program. Each frame has space for 9 pages, but some of us can remember when that format was the standard. Since most of our members never participated in exhibiting, a 9-page format seemed more manageable than a 16-page format.

Why club exhibiting? Why not participate in regional or national WSP shows? No local show presently exists.

There are a few factors that out-of-town shows do not offer. Some of our members are now on fixed incomes. WSP exhibiting encourages the display of material not common to the average collector, which is often expensive – collectors on fixed incomes have a hard time supporting that concept. One gentleman is 93-years young... Driving long distances and the cost of attending shows, including frame fees, would not be attractive to him. Other collector/exhibitors do not like the strict rules or lack the tools to produce professional exhibit pages.

The motivation behind the Midwest Philatelic Society (MPS) exhibit

program was to provide a club function for the purpose of expanding the show-and-tell segment of our meetings, to promote research of philatelic material, and to provide a platform where collectors could share what they learned from their collections and special interests, at their own pace, and from their unique perspective. A series of workshops support basic to intermediate exhibiting practices, how to “tell a story using stamps”, to define what exhibiting “is” and, more important, how to have fun with exhibiting. If the initial concept worked, the student club exhibitor would surely advance to the ranks of AAPE/APS exhibiting. And it has! Within the first year of activating our program, one member became active in several WSP shows, and another is preparing to enter his first show in 2013.

If you would like to learn more about our program, read the MPS exhibiting articles on our web site: www.midwestphilatelicsociety.com to better understand how we operate our exhibiting events. You will also discover event pictures and hyperlinks to the exhibits entered in competition by our members.

This construction plan was prepared to assist other clubs when it is time to build their frames. Our idea is just one of many that was invented.

Measurements should only be used to gain a practical relationship to the finished product. We used soft, light-weight wood to reduce cost. Unfortunately, Plexiglas is never inexpensive and, depending on the grade you purchase, adds much weight and cost to the finished product. Our frames were not designed to lock as it is not necessary in our environment. If you think you might eventually conduct public exhibitions, time would be better spent now to design locking mechanisms before construction begins.

No, we will not say how much our frames cost. Cost of materials related to one area of the country could also be different in another.

Learn how to perform research and tell a story about stamps. Ask yourself, “What is the significance of the stamps in my exhibit?”, and most of all, continue enjoying philately!

Frame Construction and Assembly

These exhibit frames can be constructed with intermediate carpentry/cabinet skills. Mandatory tools include: table saw, router, cross-cut saw, square, wood clamps, and pipe clamps, wood glue, Phillips screwdrivers, electric drill and bits, awl, pencils, various weights of sandpaper, paint, paint brushes, and patience. Measurements were taken from the finished product and should be treated as approximations due to the materials used and allowing for expansion and contraction.

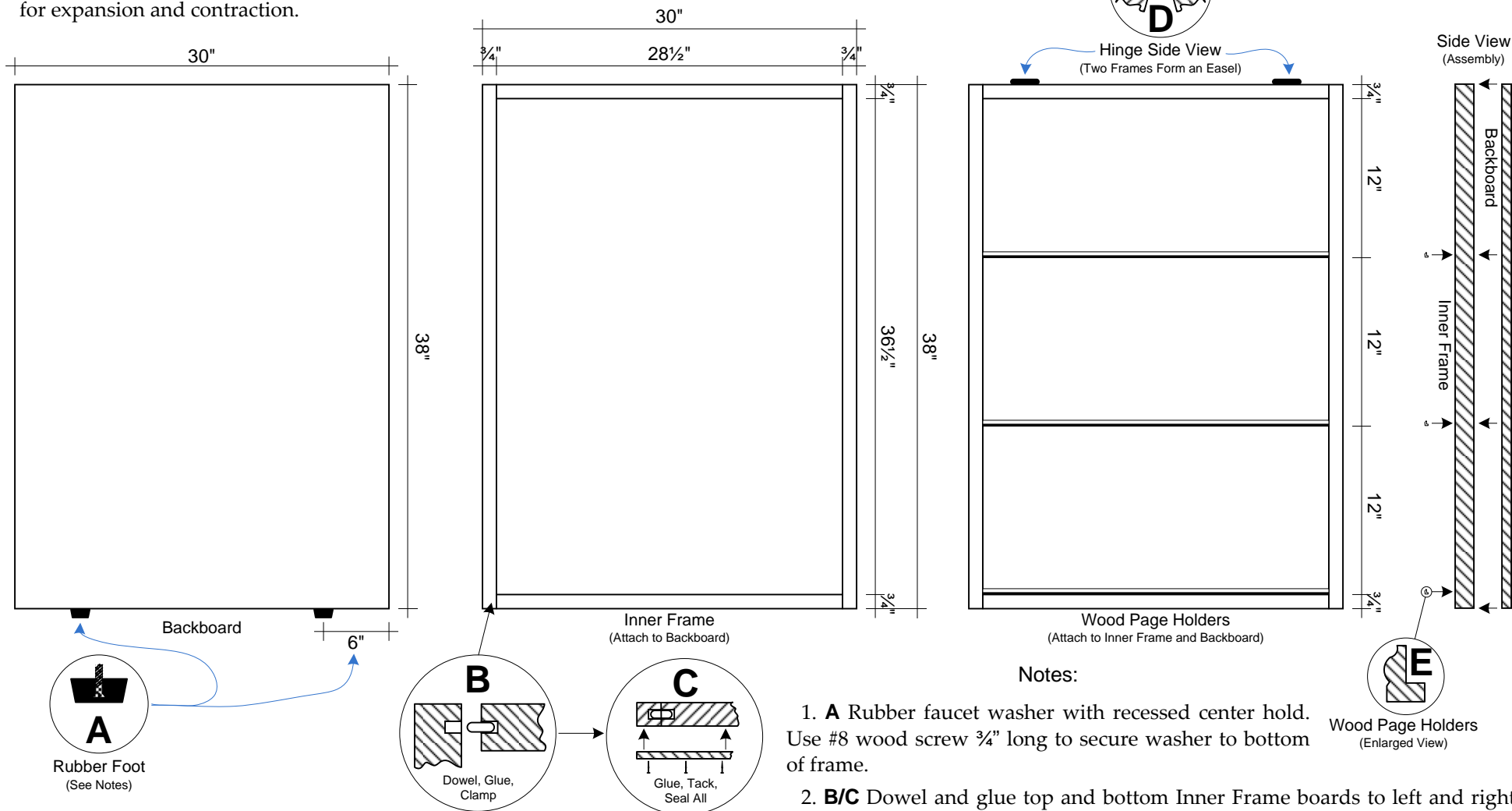

Notes:

1. **A** Rubber faucet washer with recessed center hold. Use #8 wood screw 3/4" long to secure washer to bottom of frame.
2. **B/C** Dowel and glue top and bottom Inner Frame boards to left and right Inner Frame boards. Square, clamp, and set aside until dry. Glue and tack Backboard to Inner Frame boards. Sand and apply wood sealer to all material.

3. **D** Edge of butt hinges align 6-inches from each edge of frame.
4. **E** Reduce inside depth of molding (suggest 1/4 to 1/2-inch). Caution here... when using a plainer, router, or table saw. Measure and mark equal distances inside backboard as guide for alignment. Use epoxy or wood glue to glue molding to backboard.
5. **General Note:** Inner Frame material is made from stock 1x2x8, furniture grade pine. Apply 2 coats of wood sealer to Backboard prior to assembly or painting.

Door Construction and Assembly

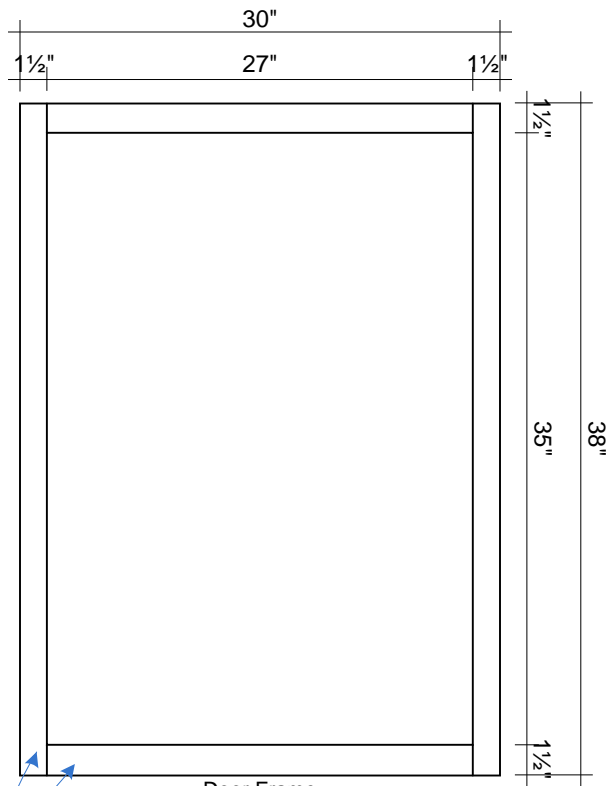

Door Frame
(Attach to Inner Frame)

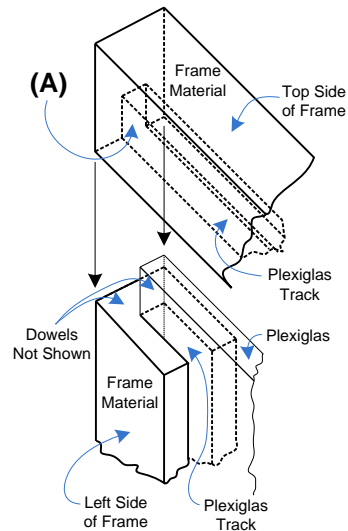

Notes:

1. Plexiglas extends above and below side frames to fit into Plexiglas track in top and bottom frame boards. Cut Plexiglas length and width for a comfortable fit to prevent binding. Determine size after test-fitting finished frame material.

2. **(A)** This area can be filled with a wood shim, glue, and putty, then sanded along the outer side of material for a finished look.

3. **B/C** Pre-drill hole to accommodate wood screw between dowels; extend into both pieces of wood. Countersink top of hole to recess screw head. Putty and sand for finished appearance.

4. Square and clamp top, left, and right frame pieces: let stand for 24-hours minimum. The bottom frame board completes assembly after Plexiglas has been installed.

5. Painting and sealing should be finished before inserting Plexiglas into frame.

6. **General Note:** Door Frame material is made from stock 1x4x8, furniture grade pine.

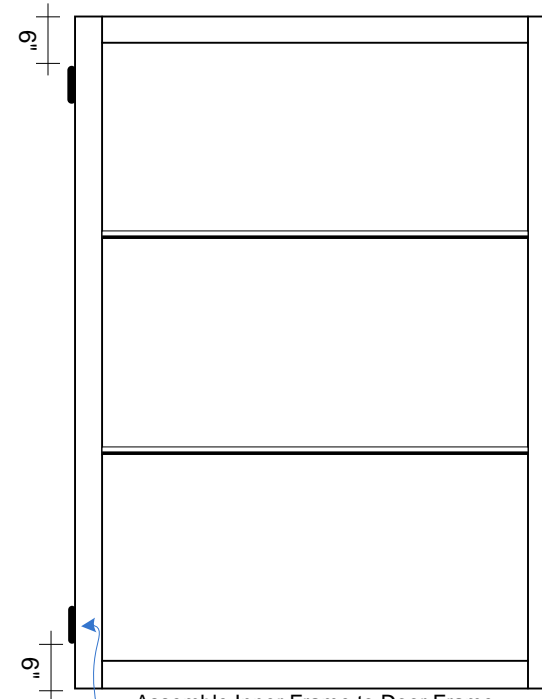

Assemble Inner Frame to Door Frame
(Attach to Left Side of Inner Frame)

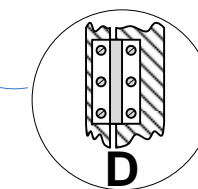

Hinge Side View
(Attach Left Side of Inner Frame
to Left Side of Door Frame)

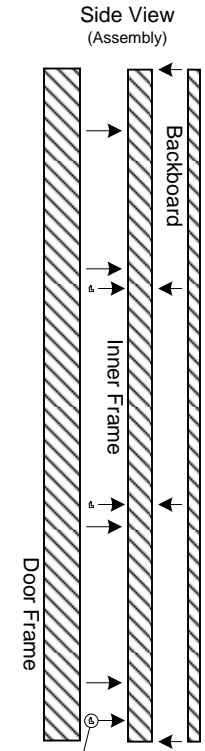

Wood Page Holders
(Enlarged View)

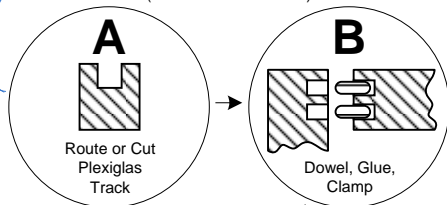

Route or Cut
Plexiglas
Track

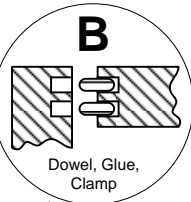

Dowel, Glue,
Clamp

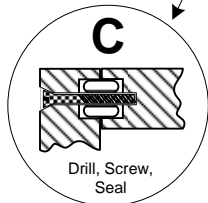

Drill, Screw,
Seal

Plan View – Door Open

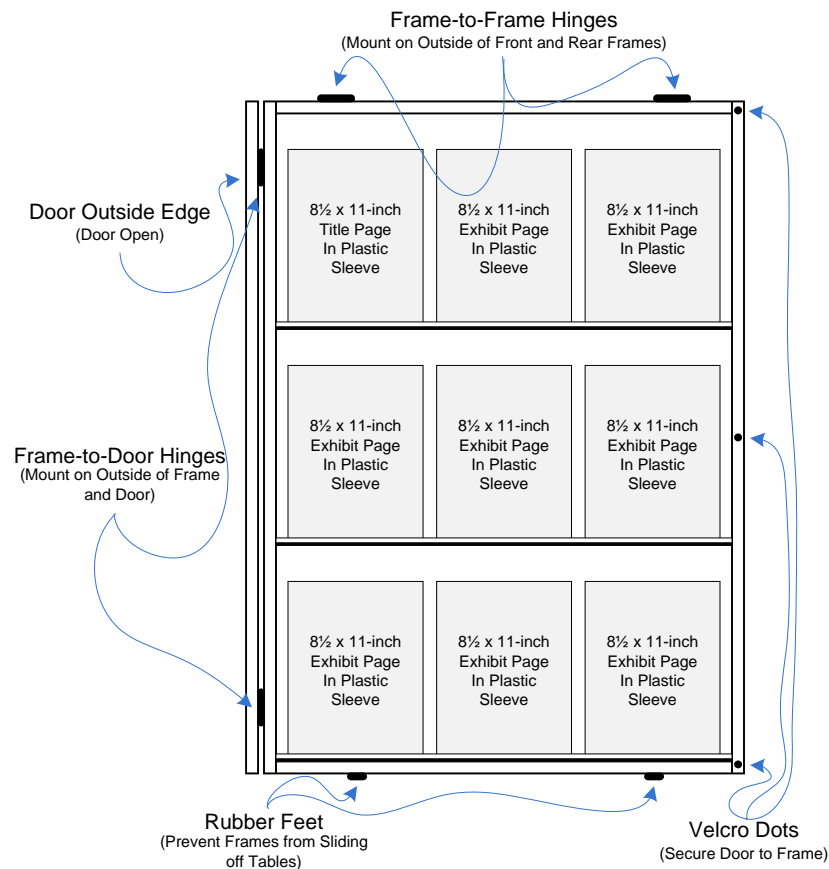

Plan View – Door Closed

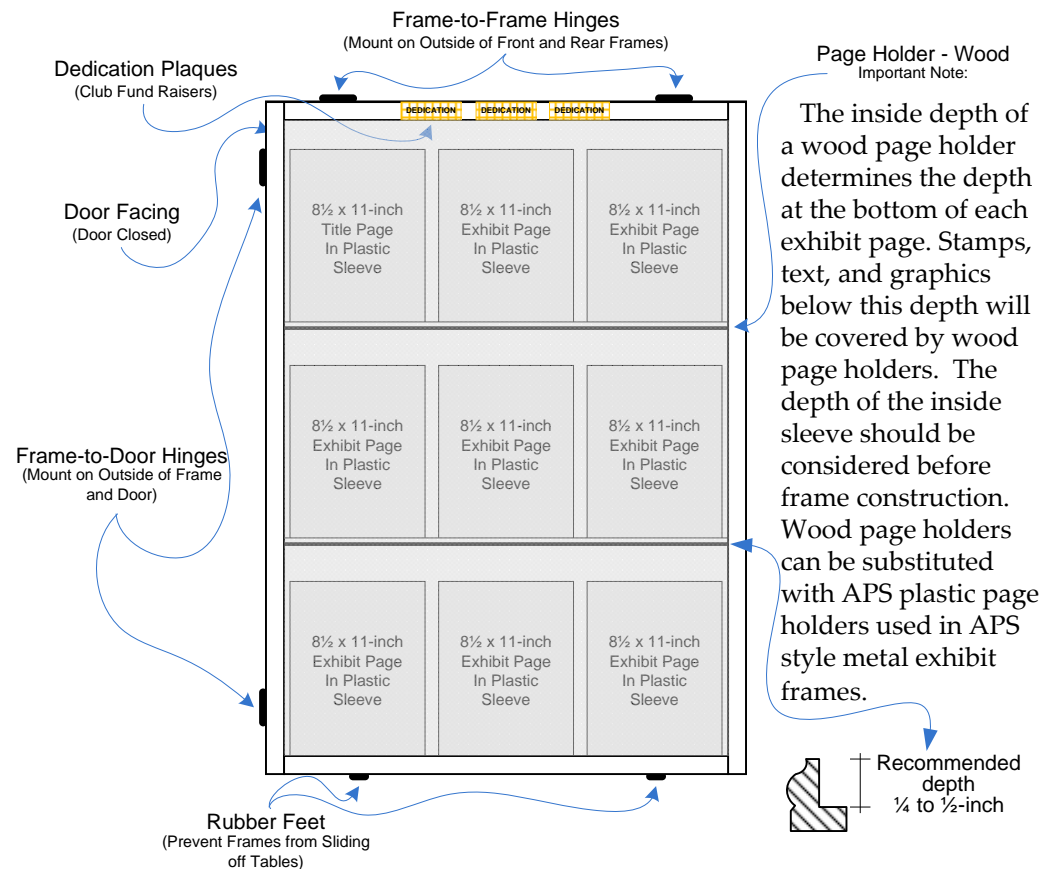

Notes:

1. Exhibit frames accept 11 x 17-inch pages in landscape position, Scott or Linder album pages, and most popular stock pages.
2. Keep door closed by applying Velcro self-adhesive dots or strips on inside edge of frame and door (after painting and sealing). This method of securing frames should be avoided if exhibit frames will be unattended for extended periods of time (stamp shows open to the public). Consideration for attaching locking mechanisms to exhibit frames, or securing exhibit frames to tables are not included with these instructions.
3. If exhibit frames are displayed in a secure area closely monitored by club members, consideration to eliminate the need for doors may be practice. The additional cost for wood, Plexiglas, and hinges, used in door construction adds more than three-fourths of the cost for building these frames.
4. Rubber feet are essential. Do not substitute rubber for other materials. Table tops are smooth, and when in contact with the base of wood frames, will cause the frames to slide off the edge of the table. For extra protection, consider using a rubber mat between the bottom of the exhibit frames and table tops, in addition to the rubber feet.
5. Dedication Plaques – There are several ways to generate money for the club's treasury. An engraved self-adhesive plaque for honoring members who warrant special recognition, or perhaps remembering the passing of a club member are just two ideas. The plaques should be no wider than the door frame. Several specialty shops offer services that can provide this creative work.

Exhibit Easel – Isometric View

Single Two-frame Easel without Door

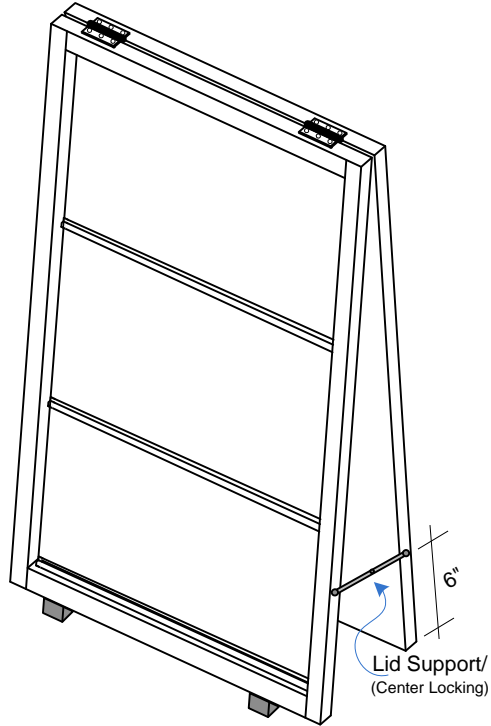

Materials List:

1. 1x2x8 furniture grade pine or poplar
2. 1x4x8 furniture grade pine or poplar
3. plywood underlayment or comparable (Backboard)
4. Premium Clear Acrylite Plexiglas: 3/16 to 1/4-inch
5. 9/16 x 1-1/8-inch finger-jointed pine Cap Molding or comparable

Hardware List:

1. Brass Utility Hinges: 6 per easel
2. Brass Lid Support/Locking: 2 per easel
3. Rubber Faucet Washer: 4 per easel
4. Screws: #8 x 3/4 (4/washers), #10 x 1-1/4 (8 Inner Frame), #10 x 2-1/4 (8 Door Frame) per easel

Sample Page Configurations

Two Easels (Two Frames Facing Front... Two Frames Behind) on a 6-foot Folding Table

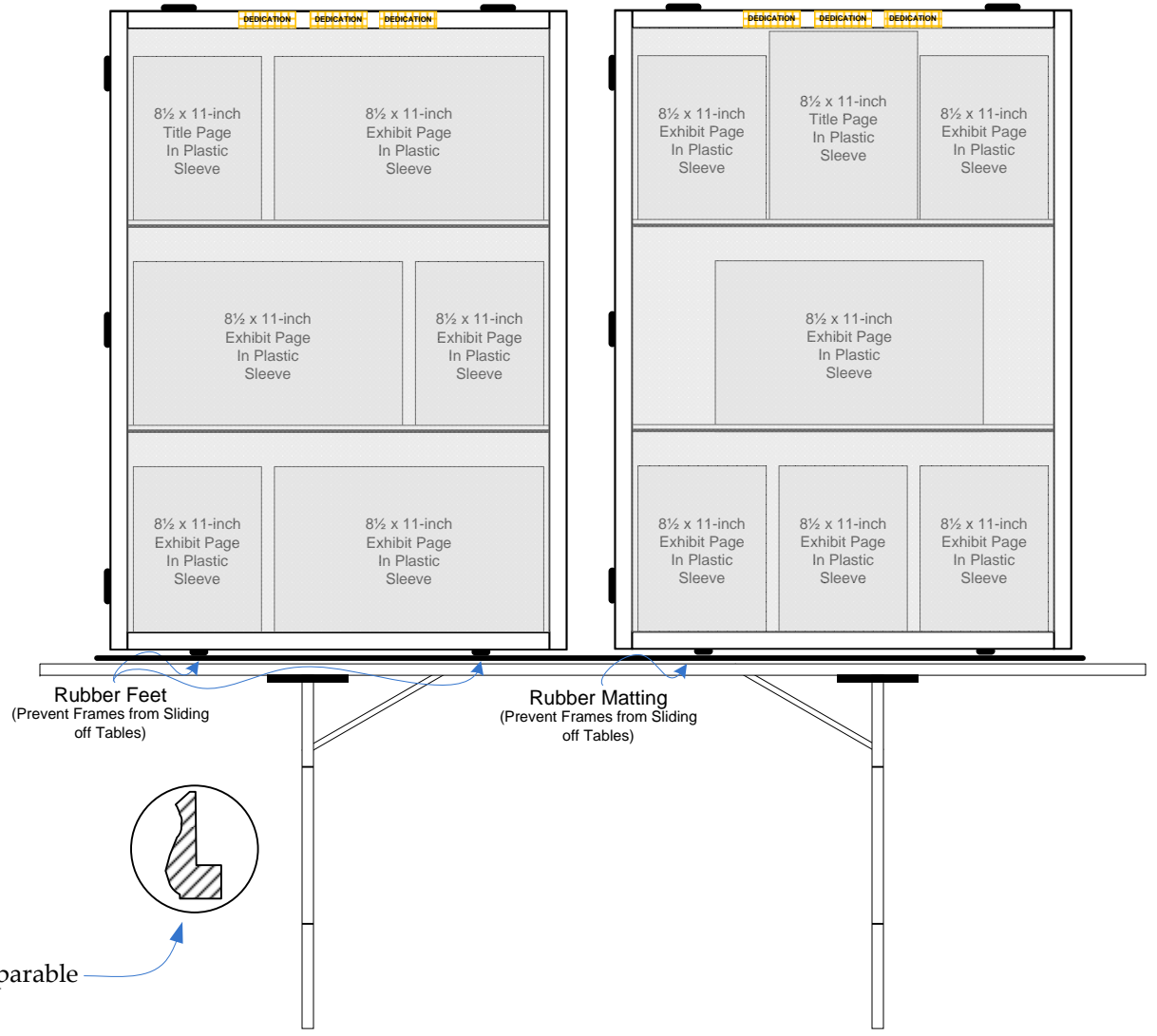

Here is an enlarged view of a 30" piece of 3/8" dowel rod. Rubber caps (available at leading hardware stores) are inserted at both ends. The tool is used to hold the Door Frame open while an exhibit pages are being placed along the wood page holders. Place the dowel rod between the top inside corner of the Inner Frame and the top inside corner of the Door Frame.